

**CBAS17**  
**LOW VOLTAGE STABISTOR**

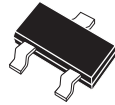

**SOT-23 CASE**

# Central<sup>TM</sup>

**Semiconductor Corp.**

**DESCRIPTION:**

The CENTRAL SEMICONDUCTOR CBAS17 type is a planar epitaxial silicon switching diode, designed for low voltage stabilizing applications.

**MARKING CODE: A91**

**MAXIMUM RATINGS:** ( $T_A=25^{\circ}\text{C}$  unless otherwise noted)

	<b>SYMBOL</b>		<b>UNITS</b>
Peak Repetitive Forward Current	$I_{FRM}$	250	mA
Power Dissipation	$P_D$	350	mW
Operating and Storage			
Junction Temperature	$T_J, T_{stg}$	-65 to +150	$^{\circ}\text{C}$
Thermal Resistance	$\Theta_{JA}$	357	$^{\circ}\text{C/W}$

**ELECTRICAL CHARACTERISTICS:** ( $T_A=25^{\circ}\text{C}$  unless otherwise noted)

<b>SYMBOL</b>	<b>TEST CONDITIONS</b>	<b>MIN</b>	<b>TYP</b>	<b>MAX</b>	<b>UNITS</b>
$V_F$	$I_F=0.1\text{mA}$	.580	.665	.680	V
$V_F$	$I_F=1.0\text{mA}$	.665	.745	.760	V
$V_F$	$I_F=5.0\text{mA}$	.725	.805	.820	V
$V_F$	$I_F=10\text{mA}$	.750	.825	.840	V
$V_F$	$I_F=100\text{mA}$	.870	.920	.960	V
$I_R$	$V_R=4.0\text{V}$			5.0	$\mu\text{A}$
$C_T$	$V_R=0, f=1\text{MHz}$			140	pF

SOT-23 CASE - MECHANICAL OUTLINE

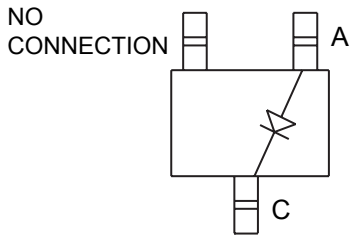
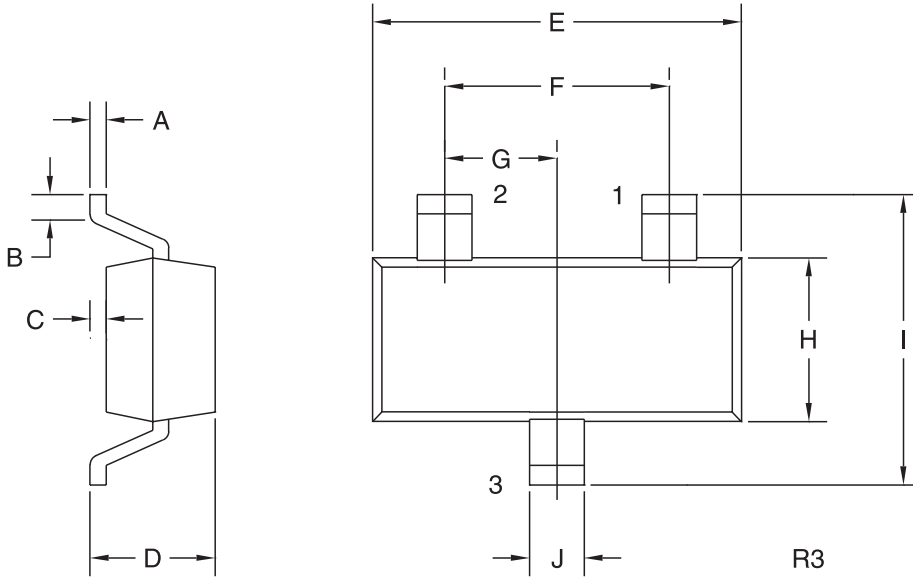

**LEAD CODE:**

- 1) ANODE
- 2) NO CONNECTION
- 3) CATHODE

**MARKING CODE: A91**

SYMBOL	INCHES		MILLIMETERS	
	MIN	MAX	MIN	MAX
A	0.003	0.007	0.08	0.18
B	0.006	-	0.15	-
C	-	0.005	-	0.13
D	0.035	0.043	0.89	1.09
E	0.110	0.120	2.80	3.05
F	0.075		1.90	
G	0.037		0.95	
H	0.047	0.055	1.19	1.40
I	0.083	0.098	2.10	2.49
J	0.014	0.020	0.35	0.50

SOT-23 (REV: R3)