

CMSH3-20L
CMSH3-40L

LOW FORWARD VOLTAGE
SCHOTTKY BARRIER RECTIFIER
3.0 AMP, 20 AND 40 VOLTS

LOW
V_F



SMC CASE

CentralTM
Semiconductor Corp.

FEATURES:

- LOW FORWARD VOLTAGE DROP
- FLAMMABILITY CLASSIFICATION UL94V-0
- HIGH CURRENT CAPABILITY
- SUPERIOR LOT TO LOT CONSISTENCY
- LOW COST
- "C" BEND CONSTRUCTION PROVIDES STRAIN RELIEF WHEN MOUNTED ON PC BOARD
- HIGH RELIABILITY

DESCRIPTION:

The CENTRAL SEMICONDUCTOR 3.0 Amp Surface Mount Low VF Schottky Rectifier is a high quality, well constructed, highly reliable component designed for use in all types of commercial, industrial, entertainment, computer, and automotive applications where high efficiency is required. To order devices on 12mm Tape and Reel (3000/13" Reel), add TR13 suffix to part number.

MARKING CODES:

CMSH3-20L: CS320L

CMSH3-40L: CS340L

MAXIMUM RATINGS: (T_A=25°C unless otherwise noted)

	SYMBOL	CMSH3-20L	CMSH3-40L	UNITS
Peak Repetitive Reverse Voltage	V _{RRM}	20	40	V
DC Blocking Voltage	V _R	20	40	V
RMS Reverse Voltage	V _{R(RMS)}	14	28	V
Average Forward Current(T _L =75°C)	I _O		3.0	A
Peak Forward Surge Current (8.3ms)	I _{FSM}		100	A
Operating and Storage				
Junction Temperature	T _J , T _{stg}	-65 to +150		°C
Thermal Resistance	θ _{JL}	10		°C/W

ELECTRICAL CHARACTERISTICS: (T_A=25°C unless otherwise noted)

SYMBOL	TEST CONDITIONS	MIN	TYP	MAX	UNITS
I _R	V _R =Rated V _{RRM}			0.50	mA
I _R	V _R =Rated V _{RRM} , T _A =100°C			20	mA
V _F	I _F =3.0A (CMSH3-20L)			0.38	V
V _F	I _F =3.0A (CMSH3-40L)			0.40	V
C _J	V _R =4.0V, f=1.0MHz		260		pF

R1 (26-September 2002)

SMC CASE - MECHANICAL OUTLINE

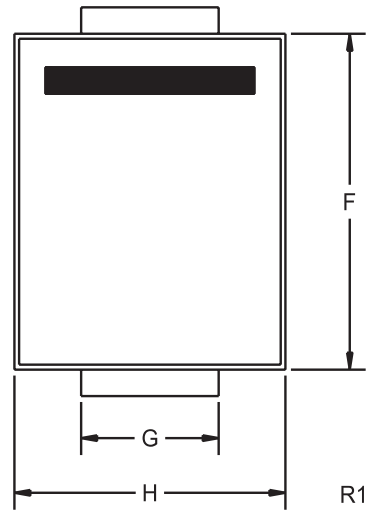
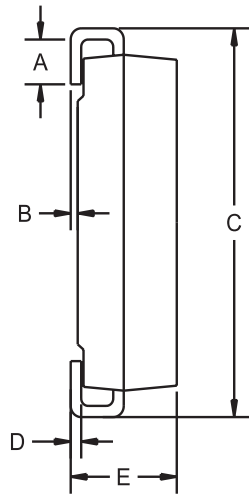

DEVICE	MARKING CODE
CMSH3-20L	CS320L
CMSH3-40L	CS340L

SYMBOL	INCHES		MILLIMETERS	
	MIN	MAX	MIN	MAX
A	0.030	0.060	0.76	1.52
B	0.004	0.008	0.10	0.20
C	0.305	0.320	7.75	8.13
D	0.006	0.012	0.15	0.31
E	0.079	0.103	2.00	2.62
F	0.260	0.280	6.60	7.11
G	0.108	0.124	2.75	3.15
H	0.220	0.245	5.59	6.22

SMC (REV: R1)